



Our Visofold folding doors are constructed from profiles with a thermal break. Robust sections enable the creation of large passage-ways providing maximum natural light and panoramic views. Moveable panels that can be folded up to the left or right sit within an outerframe. The system offers flexibility in terms of the possible combinations of folding elements and opening sashes.

This door system can be used in a variety of properties including private domestic dwellings, conservatories, hotels, restaurants and stores to open up a complete wall to create a larger space particularly advantageous in the summer.



DOORS

Visofold

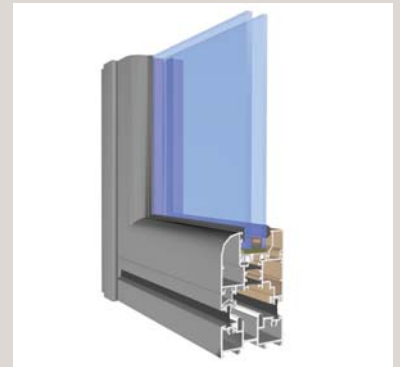

Horizontal Section

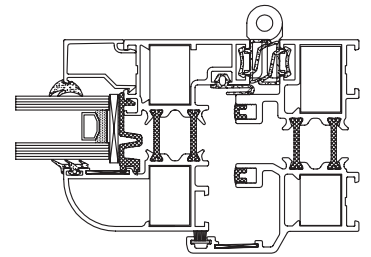

Vertical Section

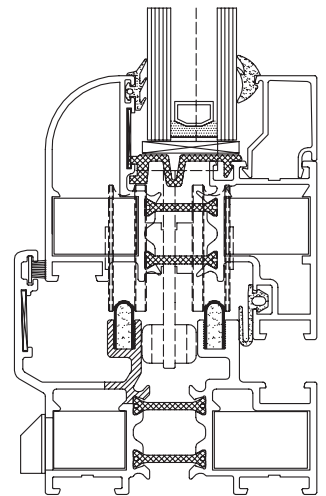

Trade Name

Visofold

Building applications

Designed for use as doors for single/double (open in or out), sliding and folding screens (open in or out) internally beaded for use in domestic dwellings, as a screen in conservatories and on all commercial applications e.g. hotels, restaurants, and stores

Special features

All applications are internally glazed with square or round edge beads. Polyamide thermal break allowing dual colour option

Materials

Aluminium alloy 6060/6063 T5/T6 in condition F22 to NBN P21-001 and DIN 1725

Thermal break: polyamide strips PA 6.6. 25% reinforced with glass fibre

Glazing seals: EPDM to DIN 7863, TV 110 NFP 85301, ISO 3994.

Weather seals: Woolpile and EPDM

Finish

Polyester powder coat to BS 6496/APA-Qualicoat Guidelines. Anodised satin or bronze colours with EWAA/EURAS-Qualinod quality label. Dual colour available. Wood-effect colour available (powder coated according to Qualicoat).

Profile width

Various options depending on design considerations

Depth of frame

Outerframe 78mm, Sash 70mm

Glass

Glazing options from 4mm to 38mm

Sash inserts

Visoline window types

Weather performance

Tests conducted in accordance with STS 52.0. Complies with Doc. L for thermal transmittance

Test Report available on request

